

This map is reproduced from Ordnance Survey material with the permission of Ordnance Survey on behalf of the Controller of Her Majesty's Stationery Office © Crown copyright. Unauthorised reproduction infringes Crown copyright and may lead to prosecution of civil proceedings. Stockport Metropolitan Borough Council 100019571 2012

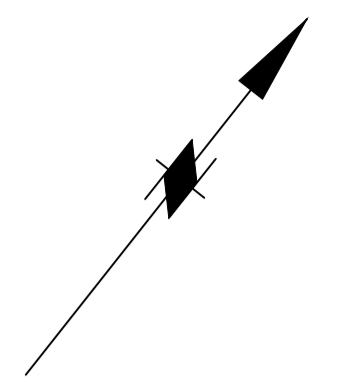

- KEY**
- EXISTING DEFINITIVE PROW
 - EXISTING BRIDLEWAY
 - LADYBROOK VALLEY INTEREST TRAIL
 - PROPOSED FENCELINE

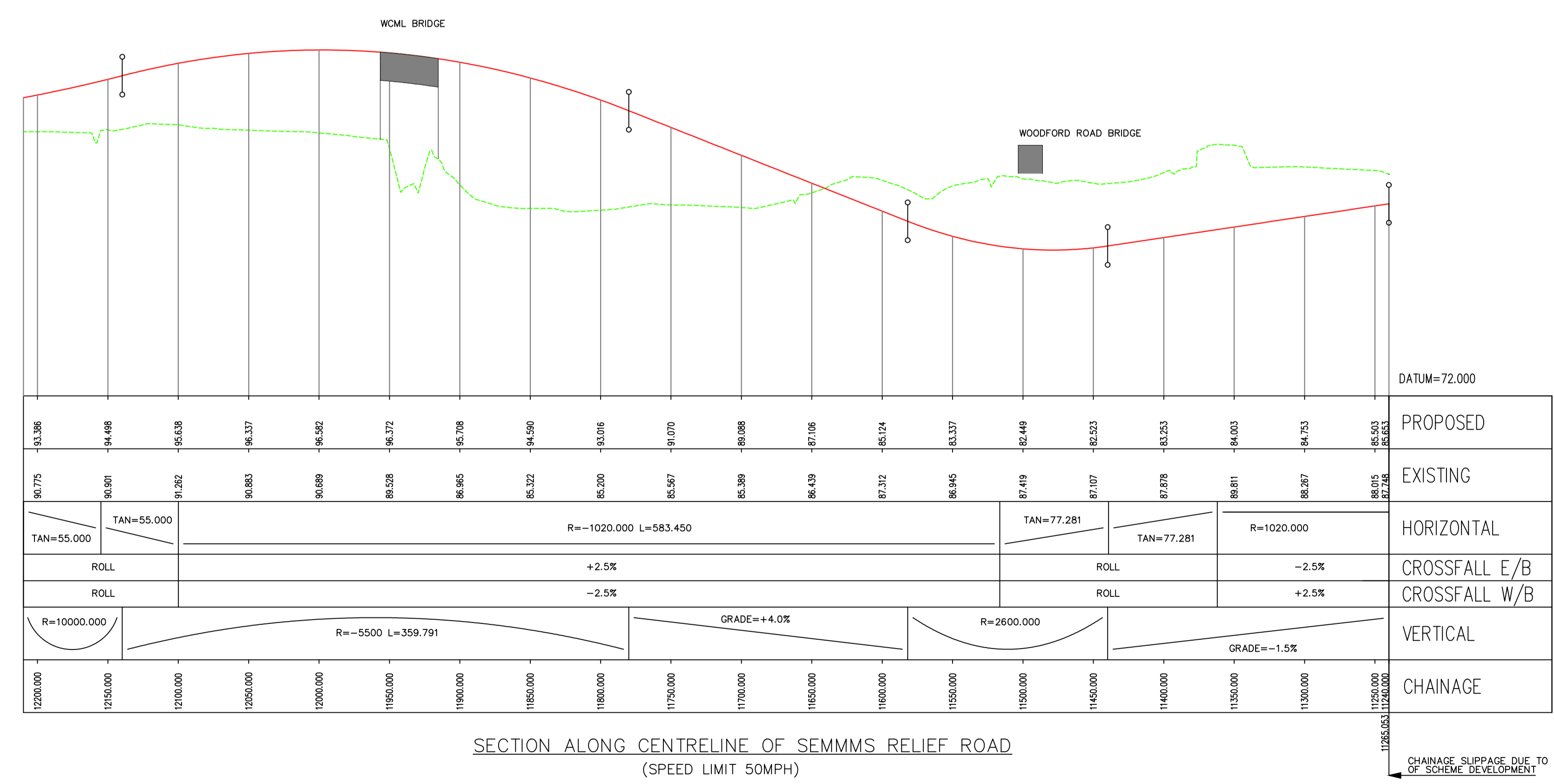
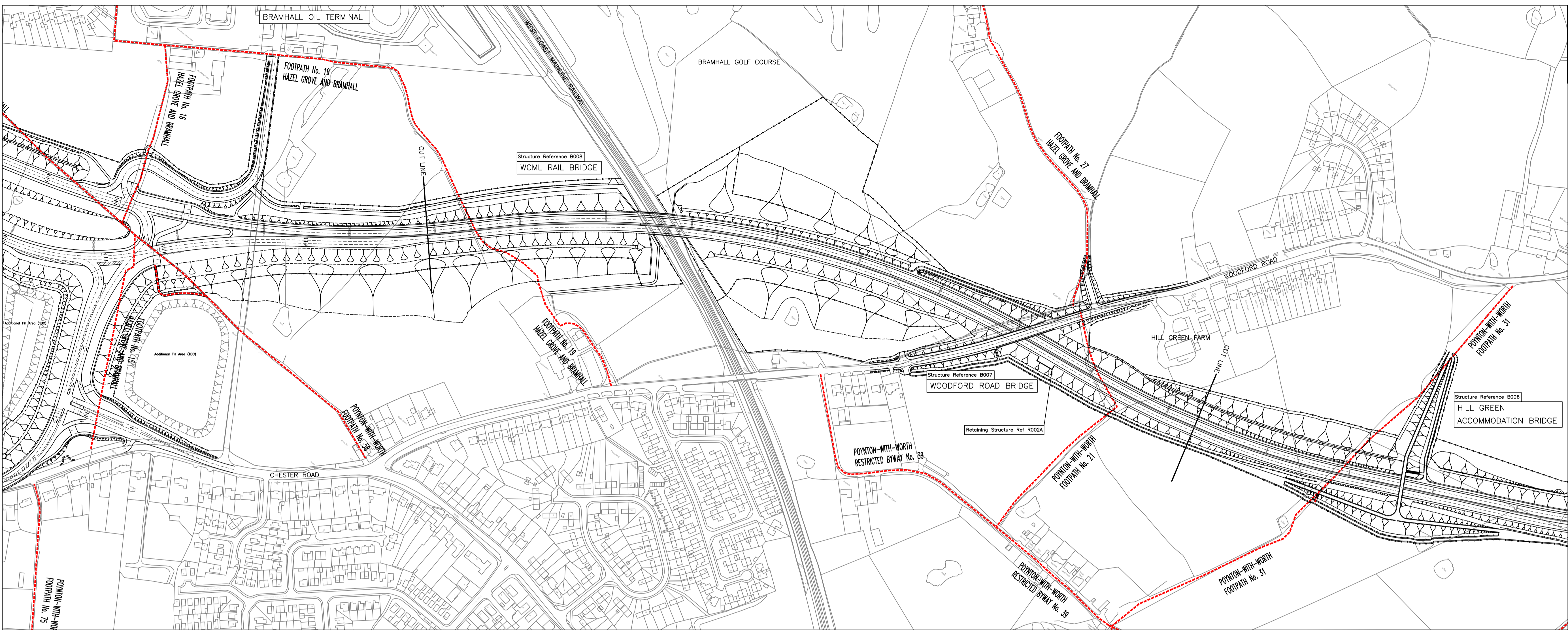

SECTION ALONG CENTRELINE OF SEMMMS RELIEF ROAD (SPEED LIMIT 50MPH)

CHAINAGE SLIPPAGE DUE TO FRAGMENTATION OF SCHEME DEVELOPMENT

Rev.	Drawn	Checked	Date	Revision Details

www.semmms.info

STOCKPORT MANCHESTER City Council

Jim McMahon BS: C.Eng. MICE SERVICE DIRECTOR, MAJOR PROJECTS

STOPFORD HOUSE STOCKPORT SK11 5JG TEL : 0161 474 4351 FAX : 0161 474 4553

Job Title

A6 to MANCHESTER AIRPORT RELIEF ROAD

Drawing Title

PLANNING APPLICATION GENERAL ARRANGEMENT SHEET 4 of 9

Drawn	Engineer	Checked	Approved
SP	SP	NH	AB
Date	Date	Date	Date
03.10.13	03.10.13	03.10.13	03.10.13
Size	Scale	Hz 1:2500, Vt 1:250	
A1			
SCG No.	Filename		
Drawing No.	Revision		
1007/3D/DF7/A6-MA/GA/204			